

DCL International – Preserving and Improving the Quality of the Air We Breathe

DCL is a leader in the design and manufacture of catalytic converters, catalytic mufflers, diesel particulate filters and stock mufflers for the air pollution control of off-highway vehicles, stationary engines, industrial processes and specialized on-highway vehicles. DCL supplies to world leading engine manufacturers, original equipment manufacturers, and aftermarket retrofit.

DCL's dedicated industrial focus is unique in the emissions control industry. To meet the specialized needs of the industrial market, we adopt an integrated approach, bringing together product development, design, manufacturing and testing all under one roof. This single-source capability enables us to provide better engineered emissions solutions that deliver outstanding performance, longer life and lower cost of ownership. Our superior product quality has made DCL the choice of customers around the world.



■ Manufacturing Facilities

■ Representatives

Diesel Particulate Filters



MINE-X[®]

SOOTFILTER[®]

Heavy Duty Diesel



DCL International Inc.
Corporate Headquarters
P.O. Box 90
Concord, Ontario
L4K 1B2, Canada
1-800-872-1968

Phone: (905) 660-6450
Fax: (905) 660-6435
e-mail: info@dcl-inc.com
web: www.dcl-inc.com

ISO 9001:2000 Registered



MINE-X SOOTFILTER®

FOR A CLEANER RUNNING DIESEL ENGINE

The MINE-X SOOTFILTER® diesel particulate filter effectively reduces particulate matter by 99.9% by particle count, and 85-95% by mass from diesel engine exhaust.

DCL diesel particulate filters are used to retrofit diesel vehicles to meet EPA or CARB requirements for particulate reduction in diesel vehicles, or simply to improve air quality around diesel engines. A vehicle or engine fitted with a DCL diesel particulate filter operates normally, using only the heat in the exhaust gas to continuously burn off particulates. With thousands of installations worldwide, MINE-X SOOTFILTER® diesel particulate filters are the industry standard for long, reliable operation. Product approvals include VERT, Japan MLIT, Sweden Environmental Zones and Denmark Road Safety & Transportation Agency.

DCL diesel particulate filters work best on post 1991 trucks and buses or Euro 1 or newer engines. Contact a DCL representative to determine the suitability of a MINE-X SOOTFILTER® diesel particulate filter for other applications.

EXHAUST TEMPERATURE REQUIREMENTS FOR EURO 2 ENGINES

- Peak: 400 °C or above
- Average: 220 °C or above
- Time above 250 °C: 40%
- Time above 300 °C: 20%
- Time above 350 °C: 10%

Custom Muffler Designs

So why is the MINE-X SOOTFILTER® diesel particulate filter the choice of customers worldwide? At DCL, we offer both standard and custom design exhaust emissions solutions to meet your requirements.

As a customized solution, the MINE-X SOOTFILTER® diesel particulate filter directly replaces the original muffler, eliminating the need for exhaust system modification. The illustrations below are examples of muffler replacements.

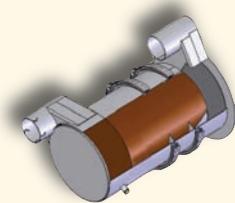

Scania Bus

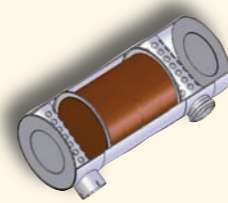

Thomas Shuttle Bus

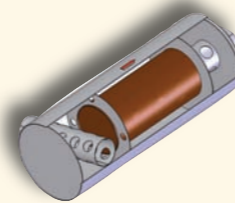

Volvo B10M Bus

How IT WORKS

The catalytically-coated ceramic monolith contains long narrow channels open at one end and blocked at the other. The exhaust gas is forced to escape by passing through the filter walls, trapping particulate matter (soot) in the filter. At a high exhaust gas temperature, the soot particles burn away and transform into harmless carbon dioxide. The filter also destroys carbon monoxide (CO) and diesel hydrocarbons (HC).

BASIC REACTIONS

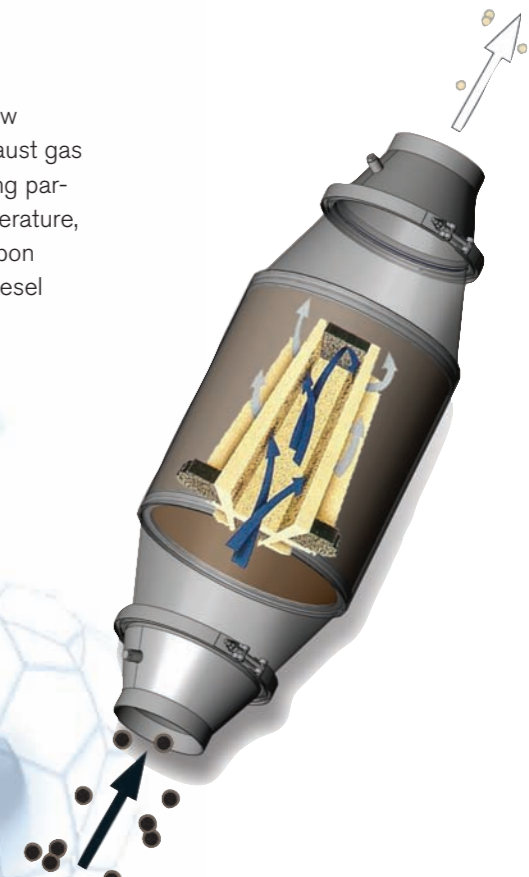
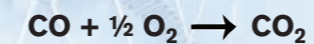
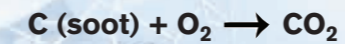

Typical Filter Performance

